

OERLIKON 20 mm/70

United States Navy type

1/350 scale

(cat.no.: SM-350-050)

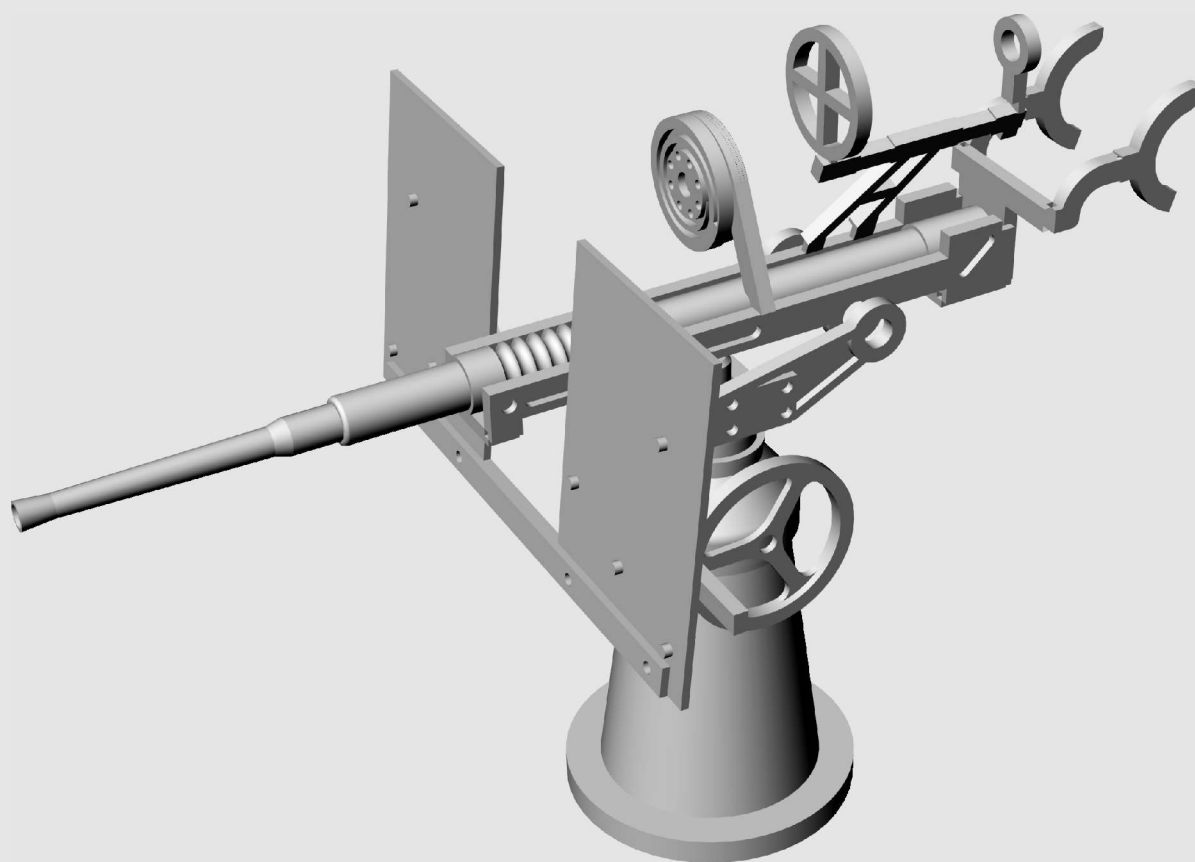

ASSEMBLY INSTRUCTIONS

DESIGN, TEXT AND PHOTOS BY
Piotr Czerkasow
Szczecin, Poland 2010

www.master-model.pl

use following adhesives and tools

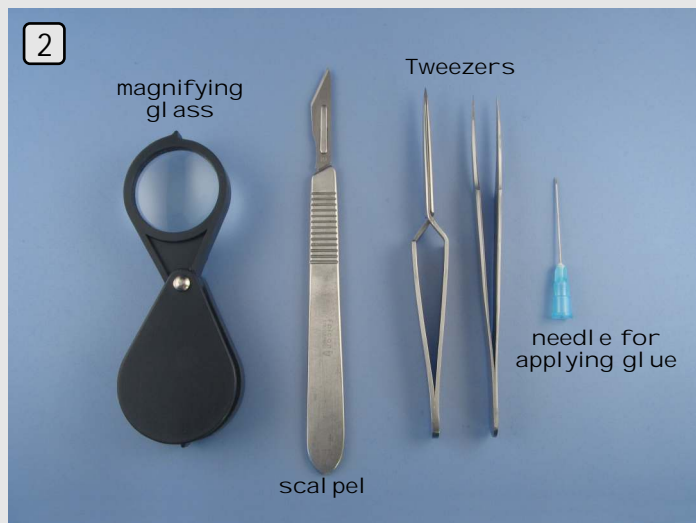
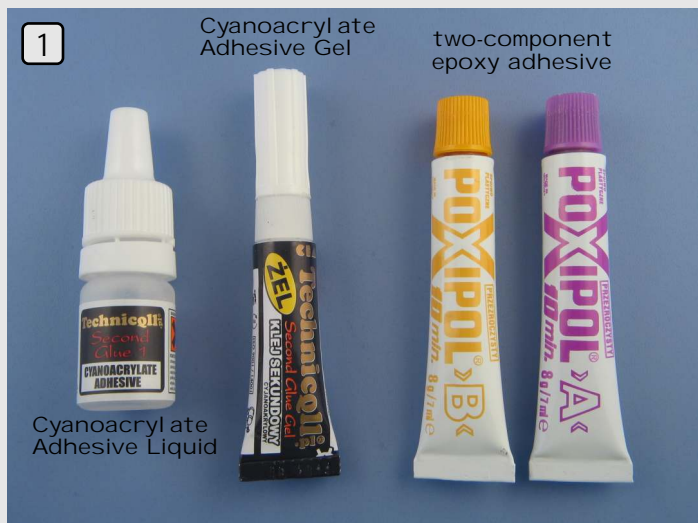

cut out parts from frame, bend and glue magazine halves

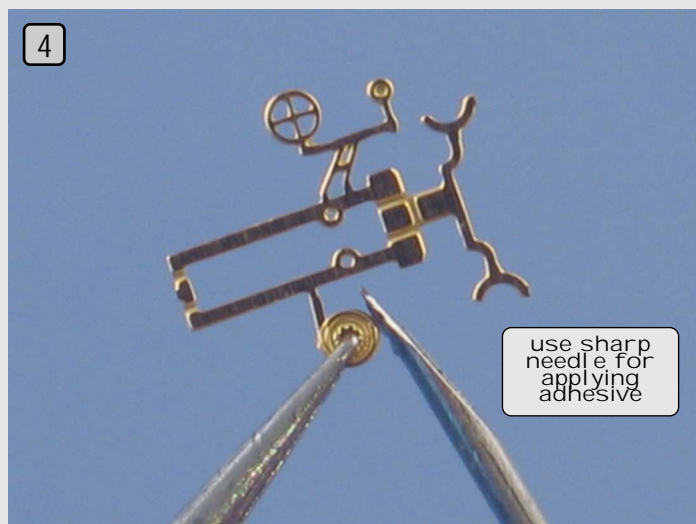
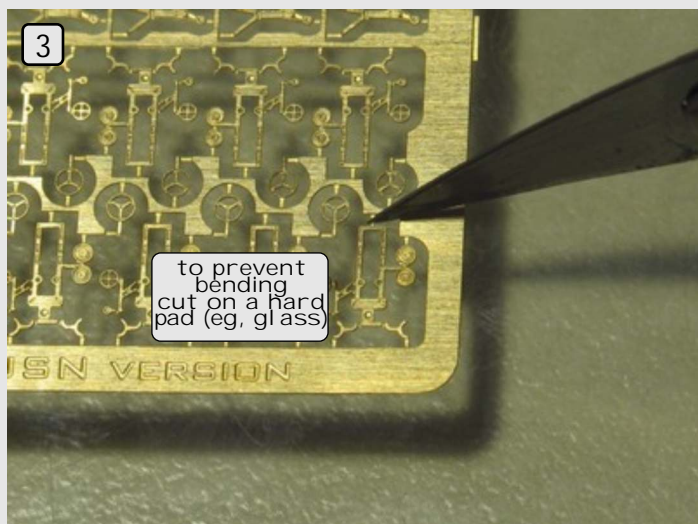

twist magazine

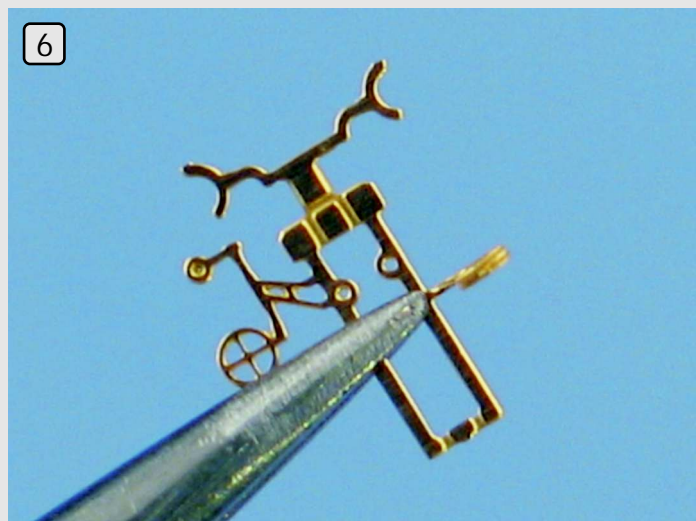
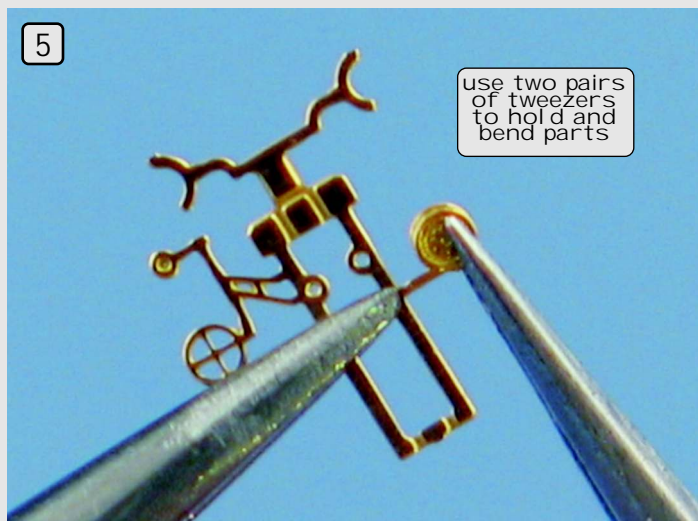

twist fore and back sights

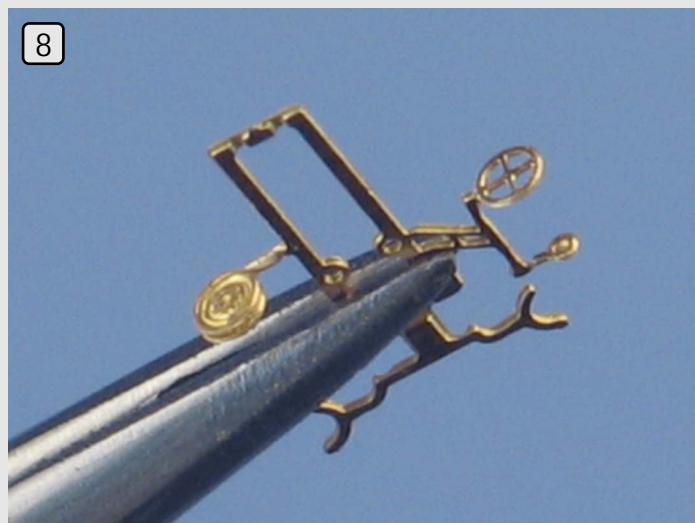
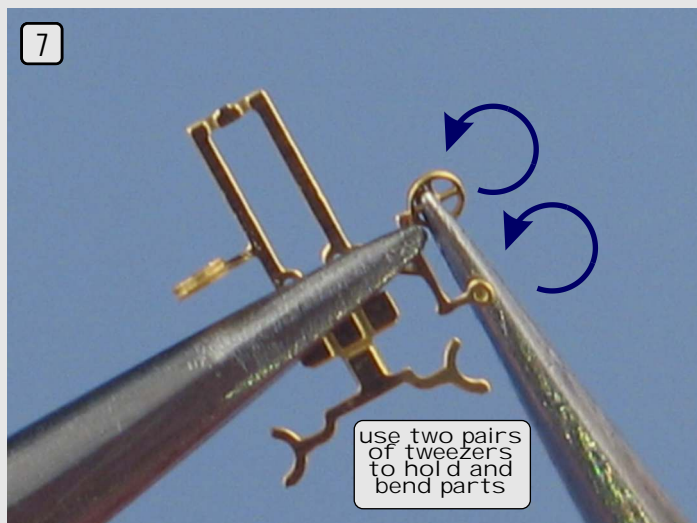

bend sight

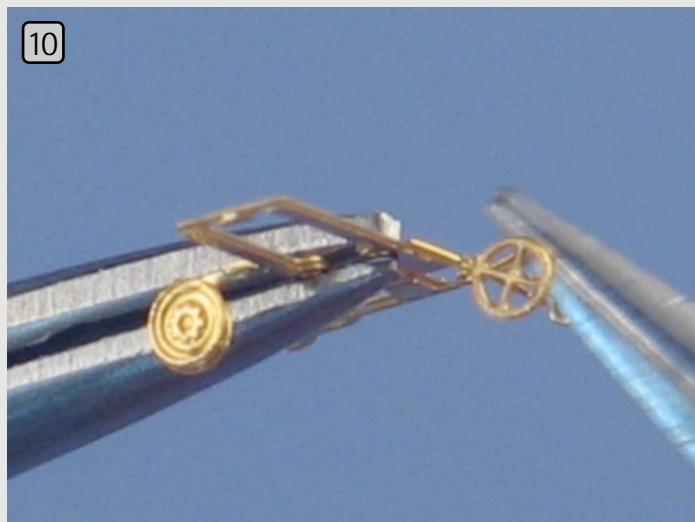
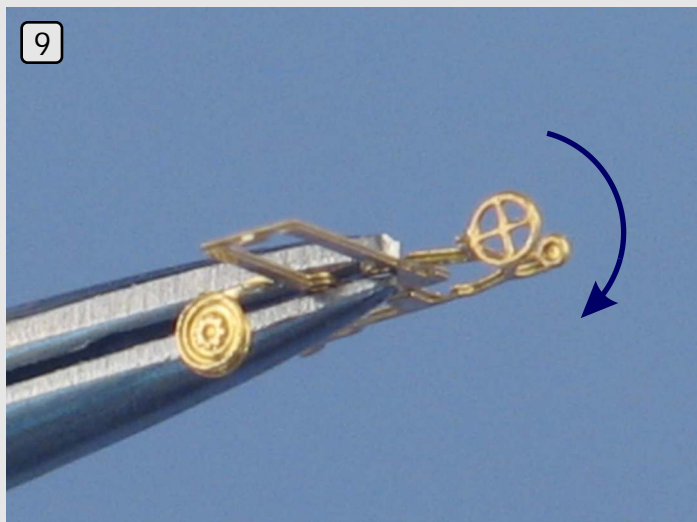

bend gun frame



correcting alignment of the gun frame

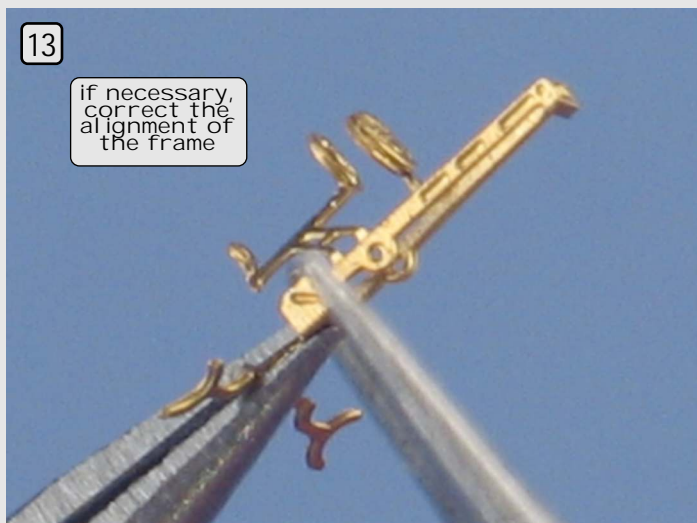

barrel assembly

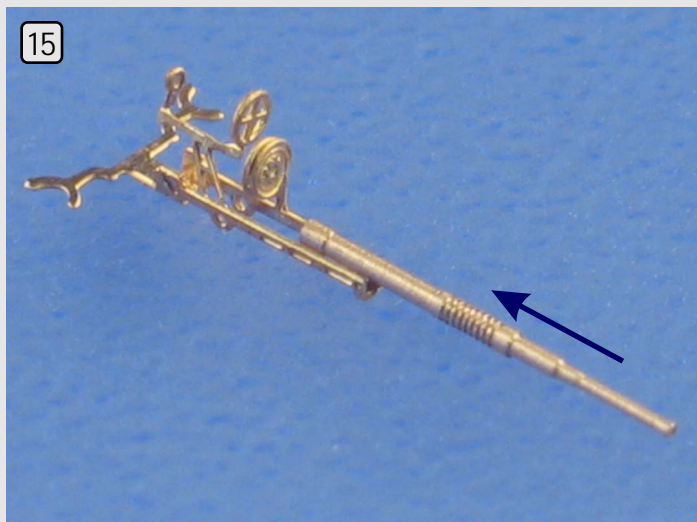

barrel assembly - glue

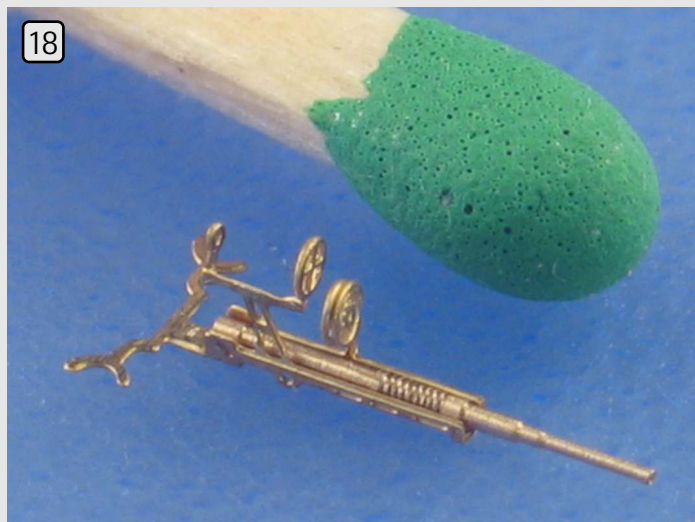
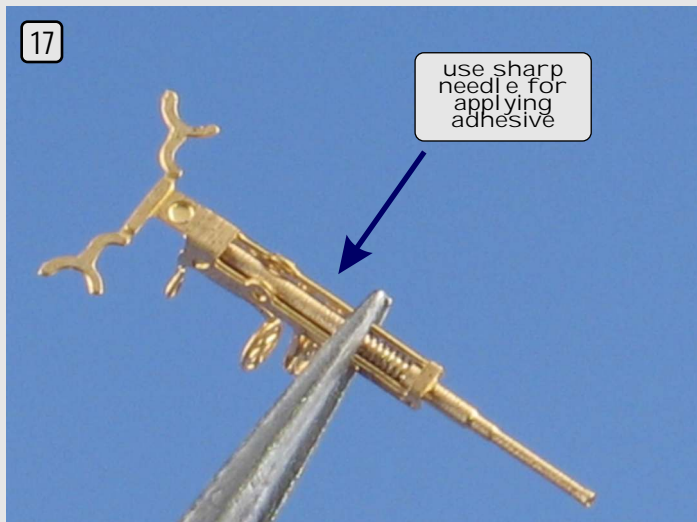

bend shoulder rests support

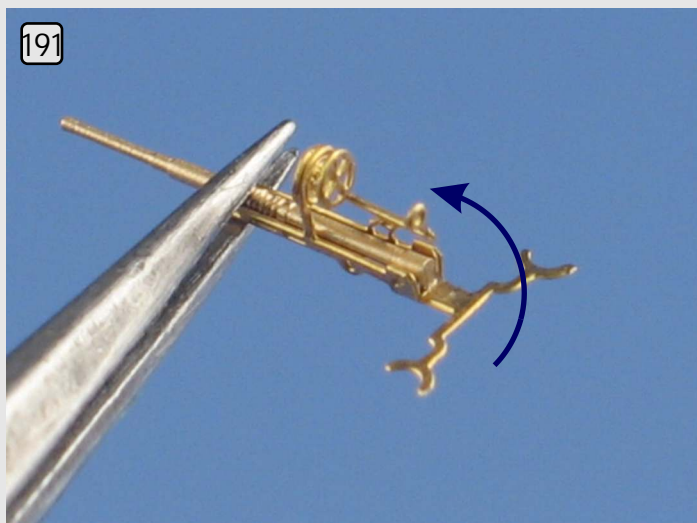

bend shoulder rests

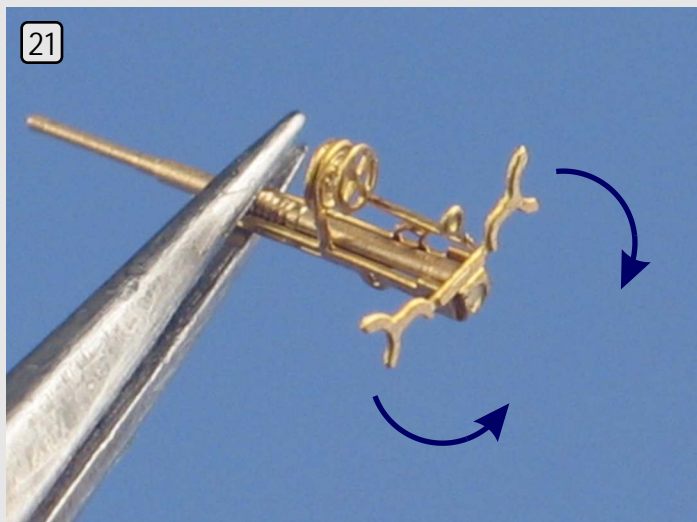

bend magazine

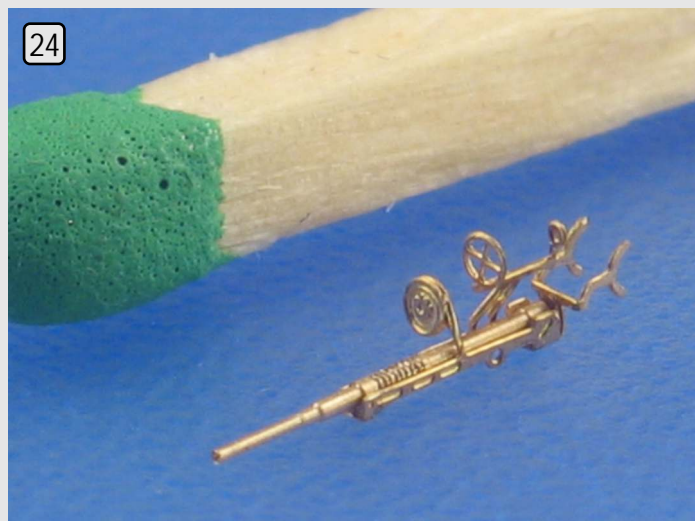
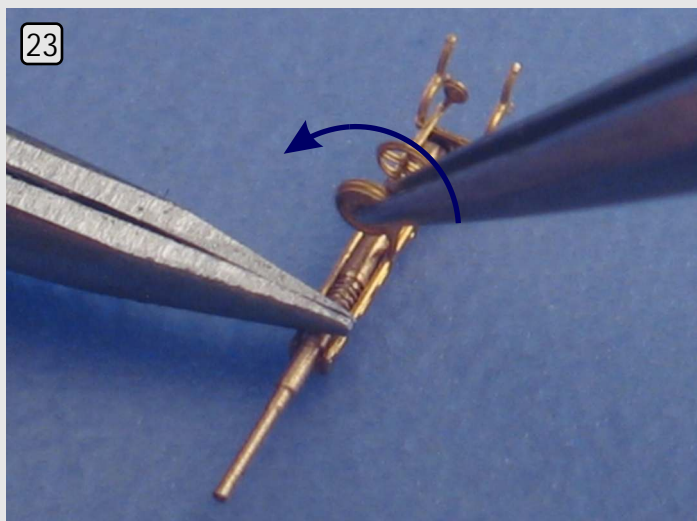

bend gun carriage

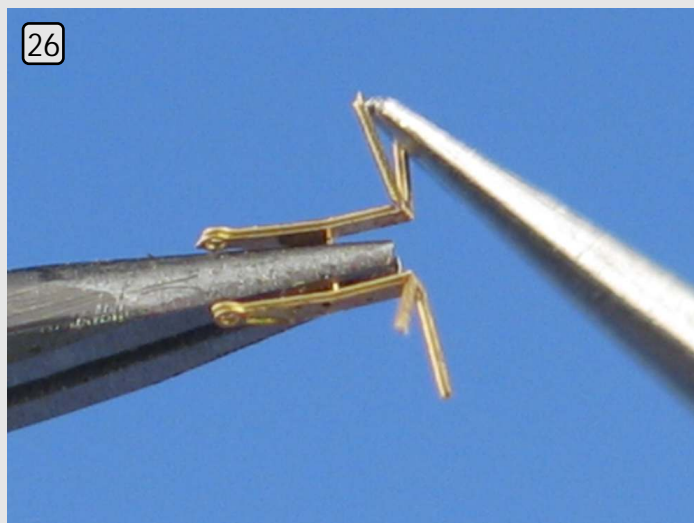
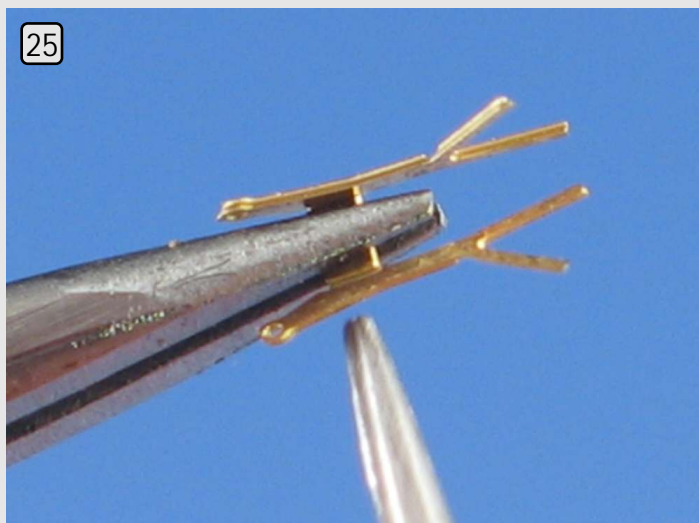

glue gun carriage to shield - preparation

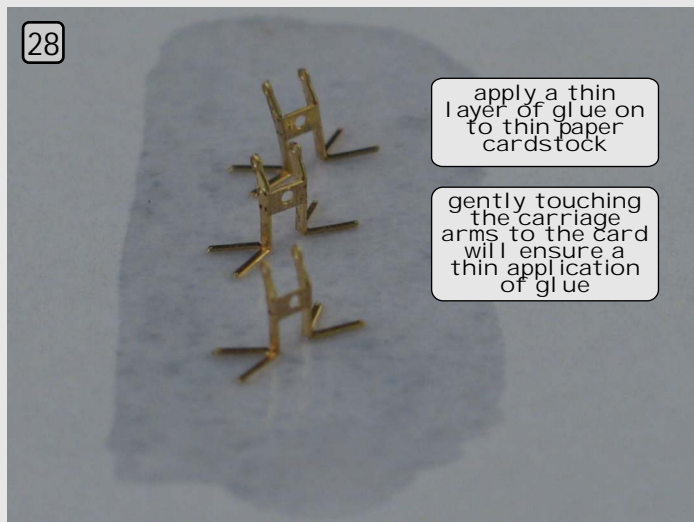
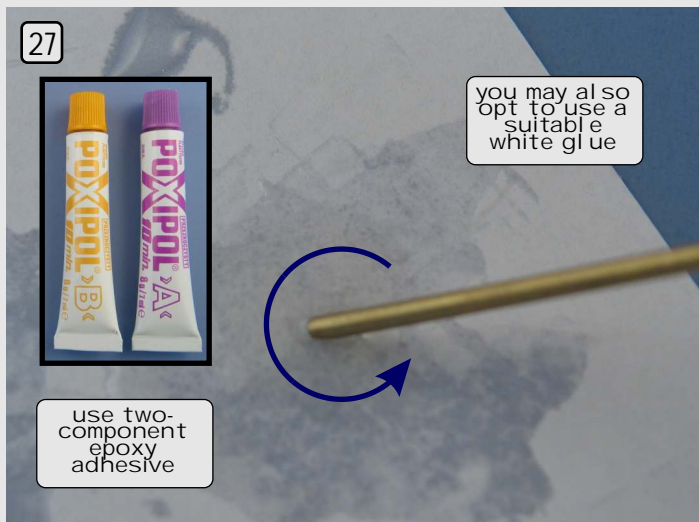

glue gun carriage to shield - assembly

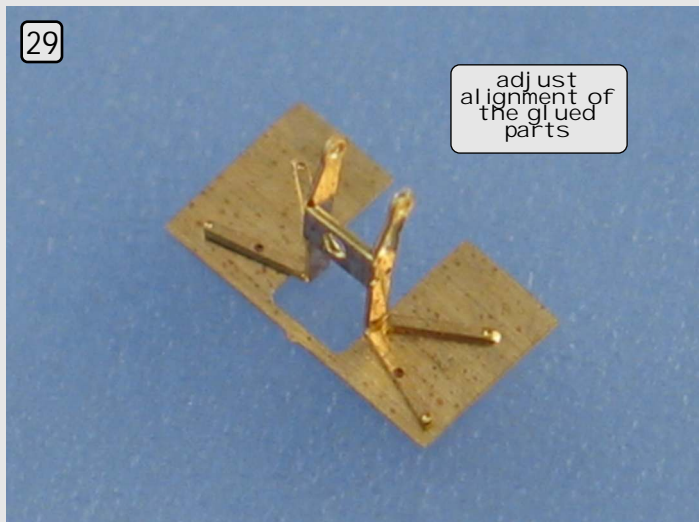

glue shield with carriage to gun pedestal

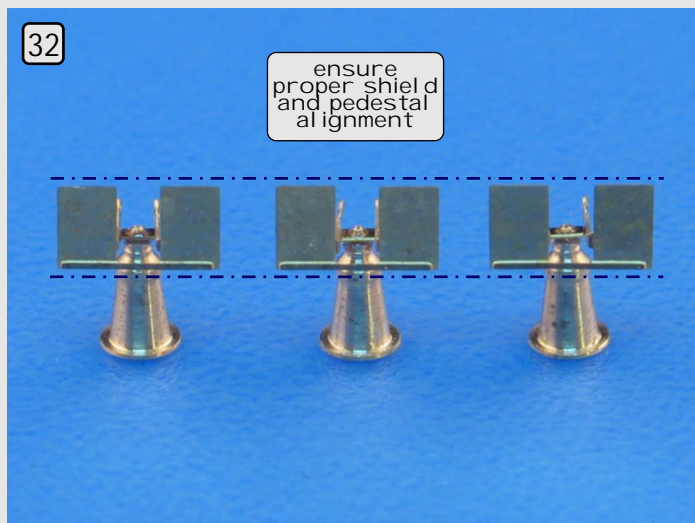
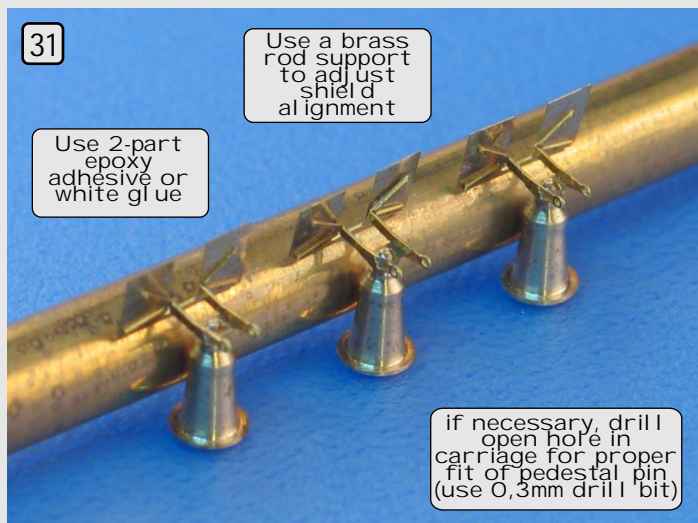

final assembly

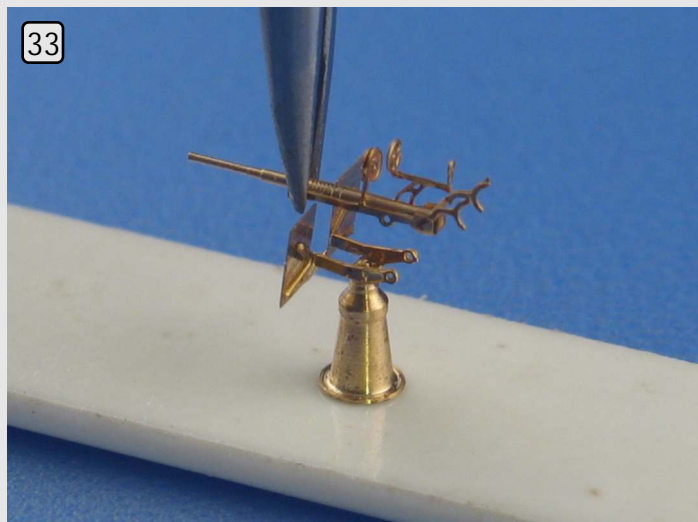

optional - movable gun cradle

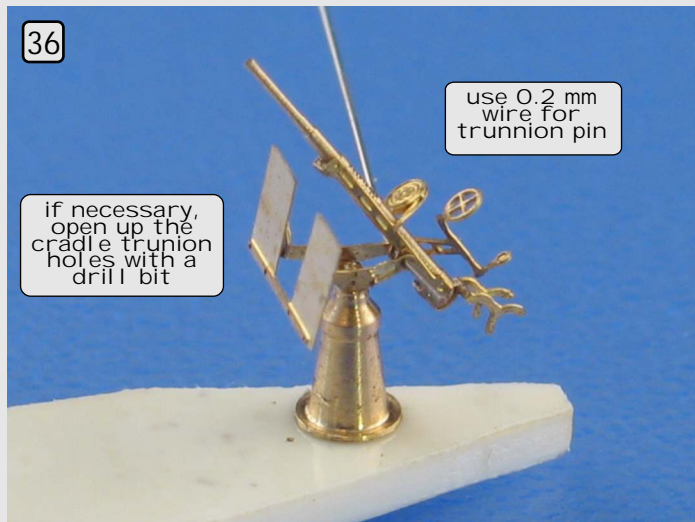

how to make the adhesive stick

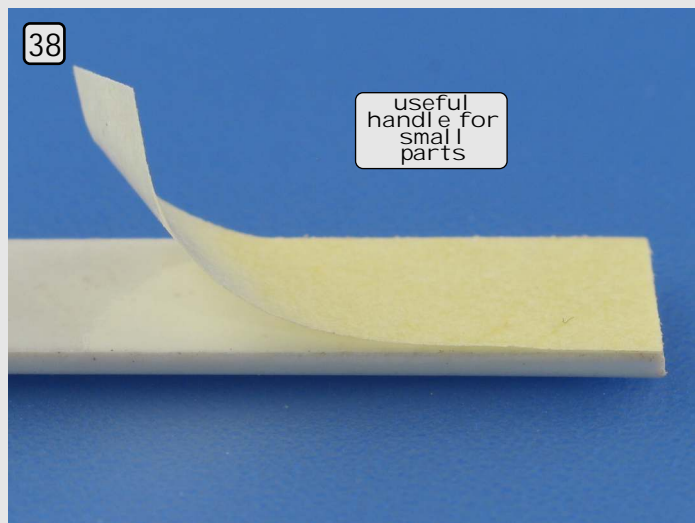
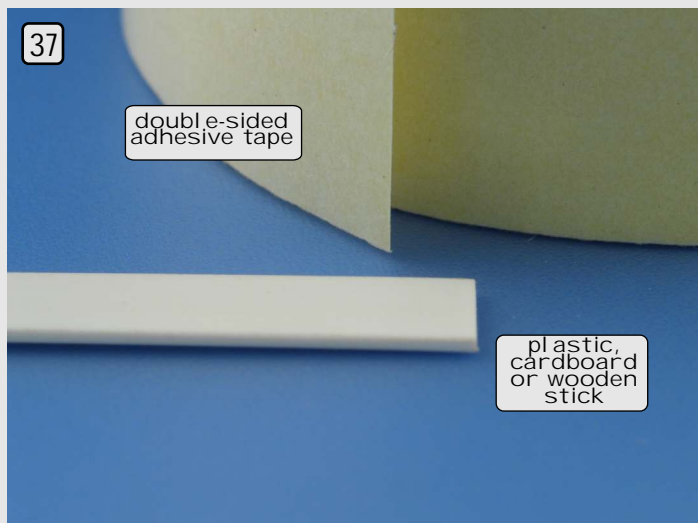

painting

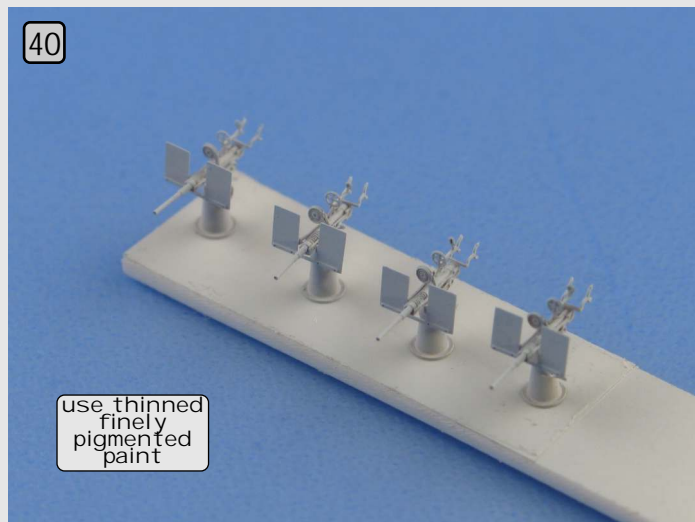
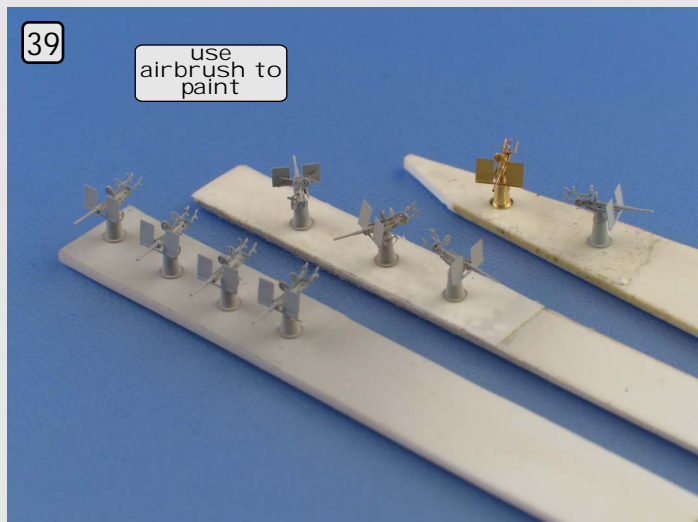

Oerlikon ready to be installed on the model

